

ASSEMBLY INSTRUCTIONS

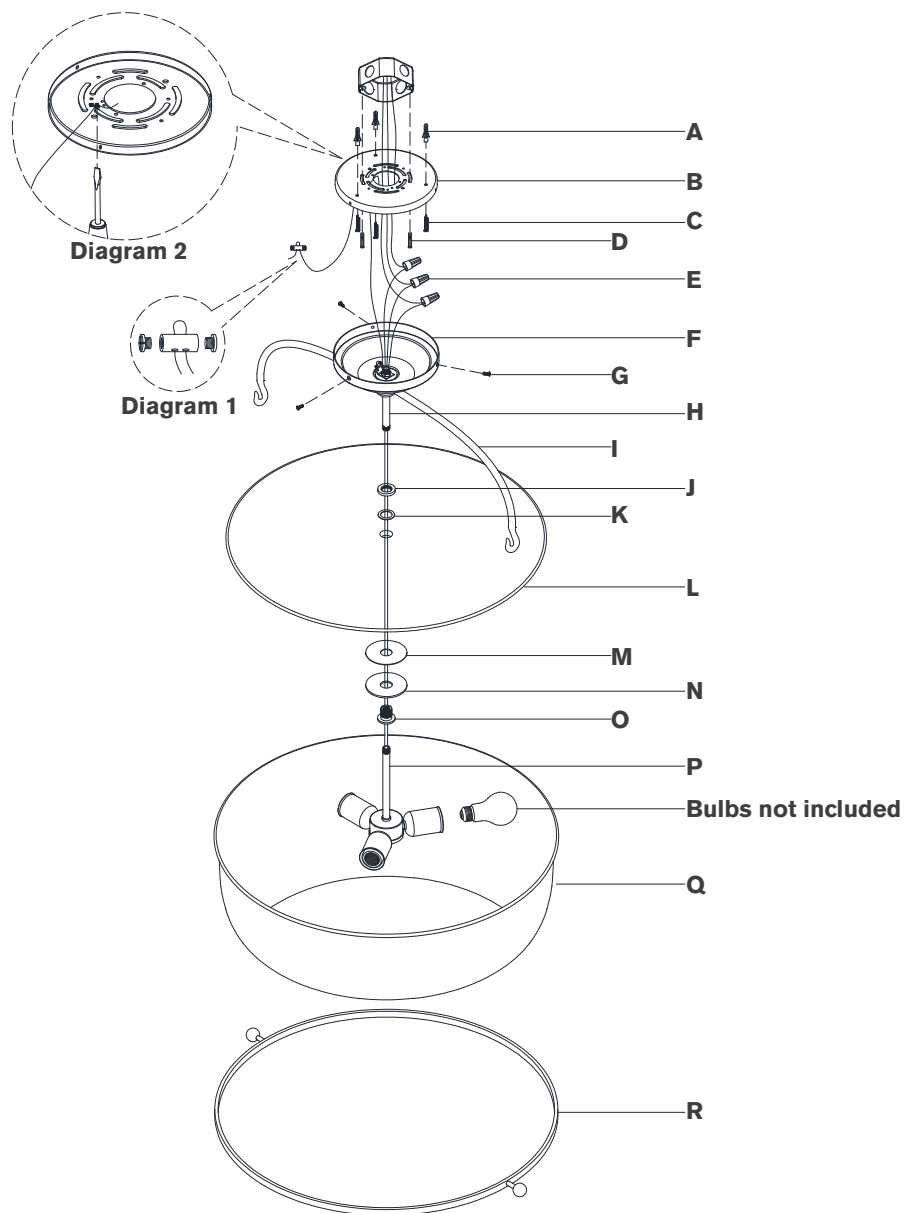

Lorford Large Semi Flush Lantern

Item # CHC 4272

NOTICE:

This light fixture should be installed in accordance with all applicable, local installation codes, and by a person familiar with the construction and operation of it, as well as the hazards involved. Inspect item and contents carefully. If any damage or defect is found, do not install. Retain all packaging material until installation is complete and approved.

TOOLS REQUIRED (NOT INCLUDED):

Phillips Screwdriver

Slotted Screwdriver

Drill

Pencil

Hammer

PERSONS REQUIRED: Two

1. Carefully remove all parts from the box. Place on a clean, soft surface.
2. Remove mounting plate **(B)** from canopy **(F)** by removing screws **(G)**.
3. Using mounting plate **(B)** as a guide, line up with the junction box and mark anchor positions.
4. Using a drill bit slightly smaller than the anchor, drill holes in the marked positions. Install anchors **(A)** into the holes using hammer.
5. Install mounting plate **(B)** to the junction box and secure with mounting screws **(D)**, then secure wood screws **(C)** to anchors **(A)**.
6. Pass fixture wires through connector **(O)**, metal washer **(N)**, rubber washer **(M)**, glass diffuser **(L)**, rubber washer **(K)**, check ring **(J)** and tube **(H)**.
7. Thread check ring **(J)** to tube **(H)**, then install rubber washer **(K)**, glass diffuser **(L)**, rubber washer **(M)**, metal washer **(N)** to check ring **(J)** and secure with connector **(O)**.
8. Thread cluster **(P)** to connector **(O)**.

NOTE: Do not over-tighten, otherwise glass could become damaged.

NOTE: It is recommended to have a helper assist in supporting the fixture for steps 9-14.

ASSEMBLY INSTRUCTIONS

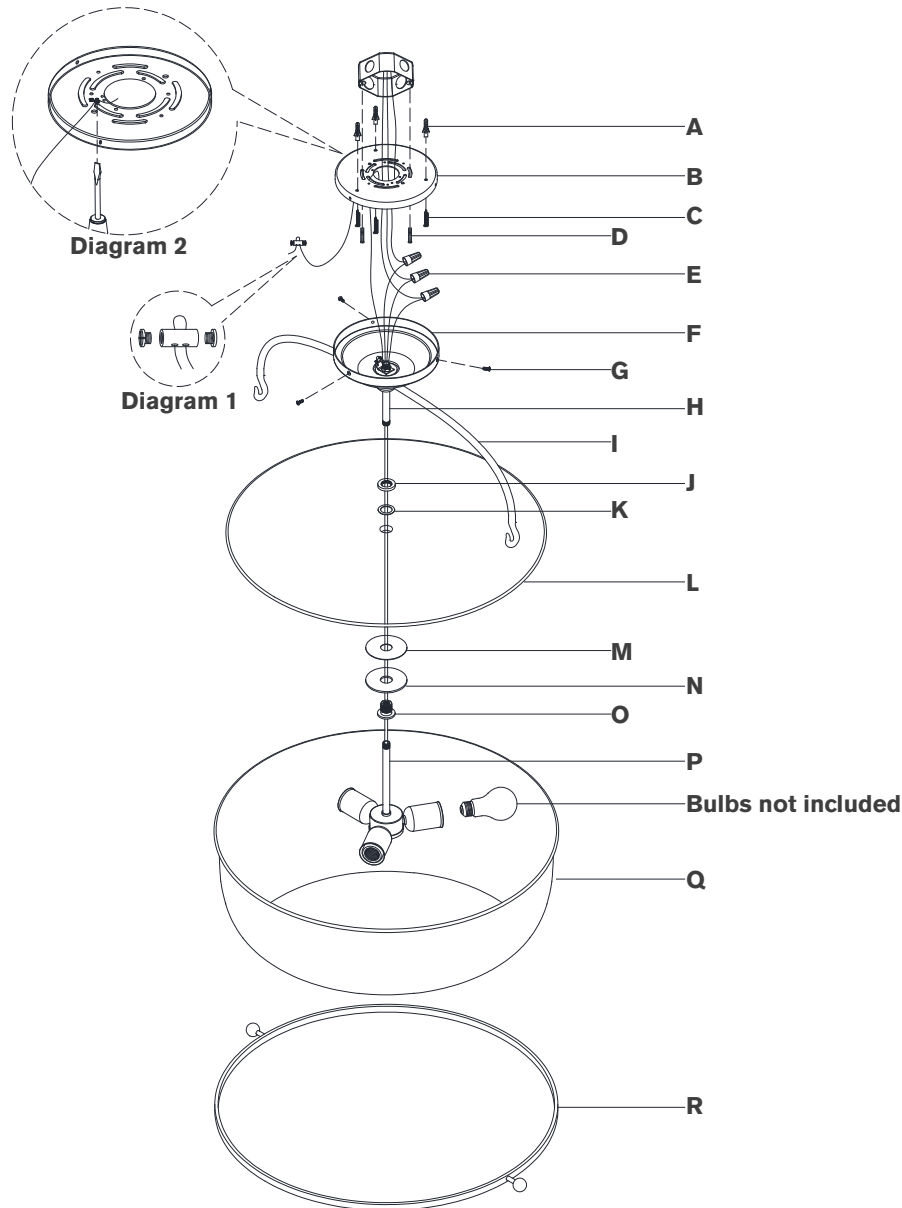

Lorford Large Semi Flush Lantern

Item # CHC 4272

NOTICE:

This light fixture should be installed in accordance with all applicable, local installation codes, and by a person familiar with the construction and operation of it, as well as the hazards involved. Inspect item and contents carefully. If any damage or defect is found, do not install. Retain all packaging material until installation is complete and approved.

- Run support cable through hole on back of mounting plate **(B)**. Loosen cable lock and install to end of support cable. Insert other end of cable through the cable lock and tighten ends with a screwdriver to secure. (see diagram 1)
- Wrap fixture ground wire (bare copper) around the green grounding screw (see diagram 2). Tighten. Continue fixture ground wire and connect to supply ground wire (usually green or bare copper) using wire nut **(E)**.
NOTE: It is imperative that the fixture is grounded.
- Connect fixture neutral wire (white) to the supply neutral wire (usually white) using wire nut **(E)**.
- Connect fixture hot wire (black) to the supply hot wire (usually black) using wire nut **(E)**.
CAUTION: Do not reverse the hot and neutral connections.
- Make sure all wire connections are tight, then carefully tuck into the junction box.
- Install canopy **(F)** to mounting plate **(B)** and secure with screws **(G)**.
- Install light bulbs into the sockets.
- Place glass shade **(Q)** onto metal ring **(R)**, then hang metal ring **(R)** to hooks **(I)**.

Care Instructions: Clean only with a soft dry cloth or feather duster. Do not use abrasive or chemical agents.